

PLANNED AMENITIES

Windermere is a stunning masterplanned community, just 38 kilometres from Melbourne’s CBD, that will emerge as a highly desirable residential address.

Right from its initial planning, amenities have been chosen to enrich the lives of residents.

With more than 50 hectares of parkland, wetlands and open space proposed for the development, including neighbouring schools and shops, residents will enjoy a high standard of amenities.

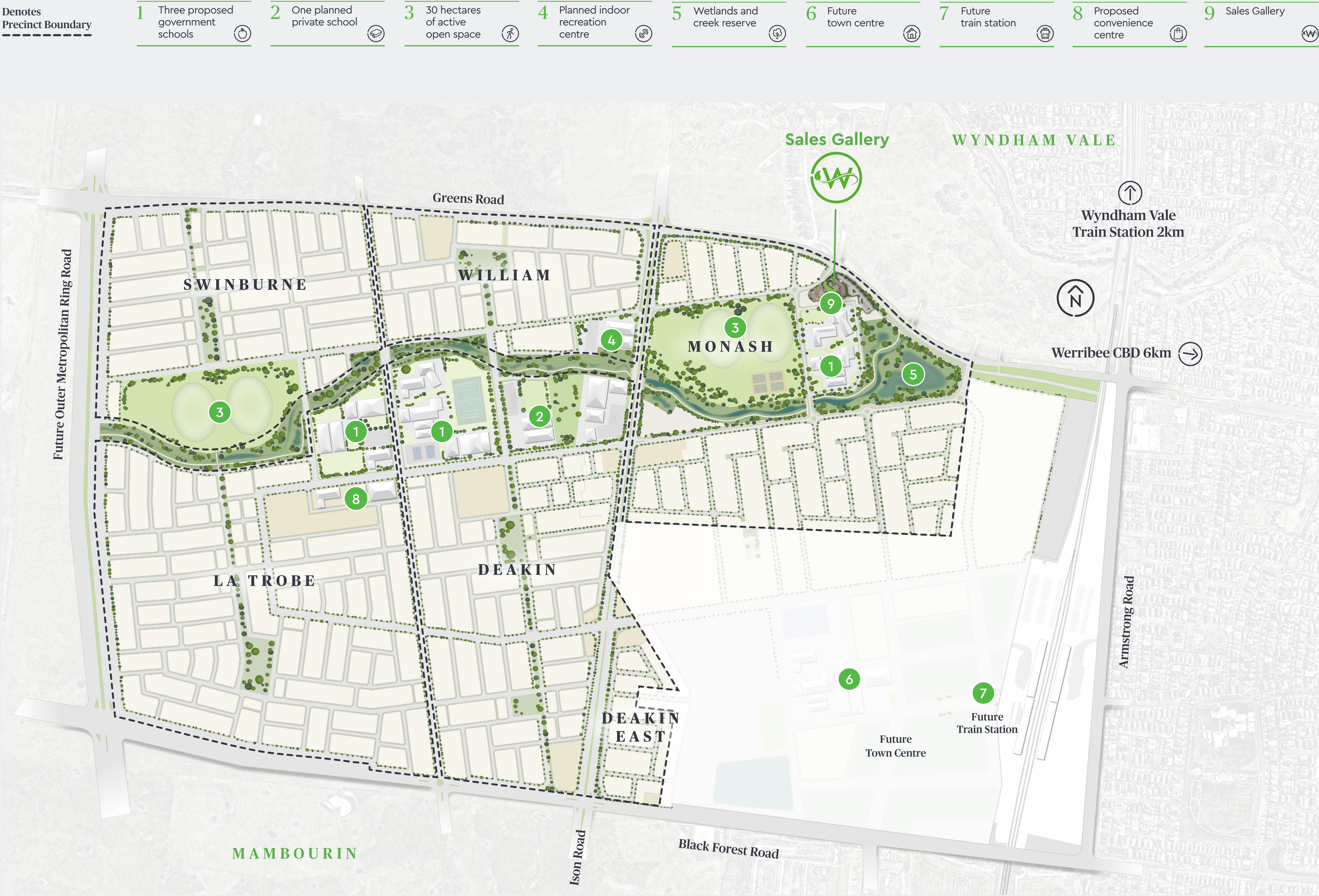

# Masterplan

WINDERMERE  
MAMBOURIN

by country garden